

56 SECURE



AI-Powered Camera

User Manual

Home Security begins with our AI camera

Your new 56 AI camera is the first line of defense around your property.

Now, you'll always be connected to your home, so you can watch over your property and take action on the go.

Set alerts and get updates on who entered your property to prevent crime and protect your home – all from your phone/tablet.

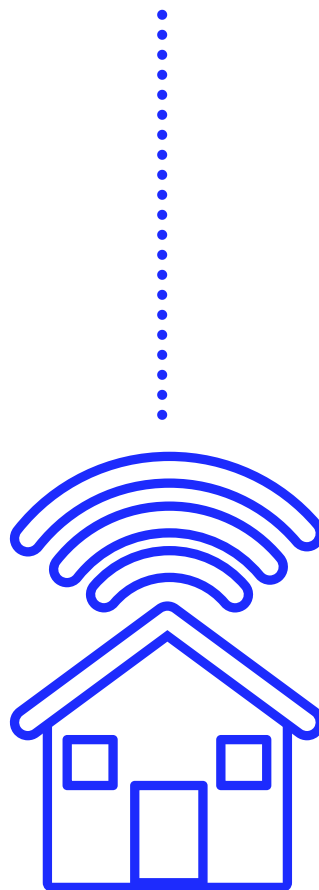

CONTENTS

I. INTRODUCTION

Get to know your AI camera.....	1
Parts of the camera.....	1
Features.....	2
Get the 56 App.....	3

II. SETUP AND INSTALLATION

Pairing the camera to your smartphone.....	4
Camera Interface.....	5
Camera Menu options.....	5

III. FEATURES

Activity section.....	6
Playback section.....	6
Adding a new user.....	7
Managing camera storage.....	7
Alerts section.....	8
Creating AI detection zone.....	9
Using AI triggered siren.....	10
Mic & Speaker usage.....	11
Out of range.....	11

IV. FAQs

AI Motion Detection.....	12
Video Privacy.....	12
Connectivity.....	13
Installation & Placements.....	13
Event Alert & Recording.....	13
Storage.....	14
App Account.....	14
Optimal Working Conditions.....	14
Highlights.....	15

V. SUPPORT.....	16
------------------------	-----------

Get to know your AI camera

Our intelligent system connects your home and camera to your smart phone to keep you safe on the go.

Our real-time, AI-powered cameras are always ON and detect anything out of the ordinary.

- Intelligent monitoring of people, vehicles, and pets
- AI detection and real-time alerts for your security
- AI zone and AI siren to get customized alerts

Parts of the camera

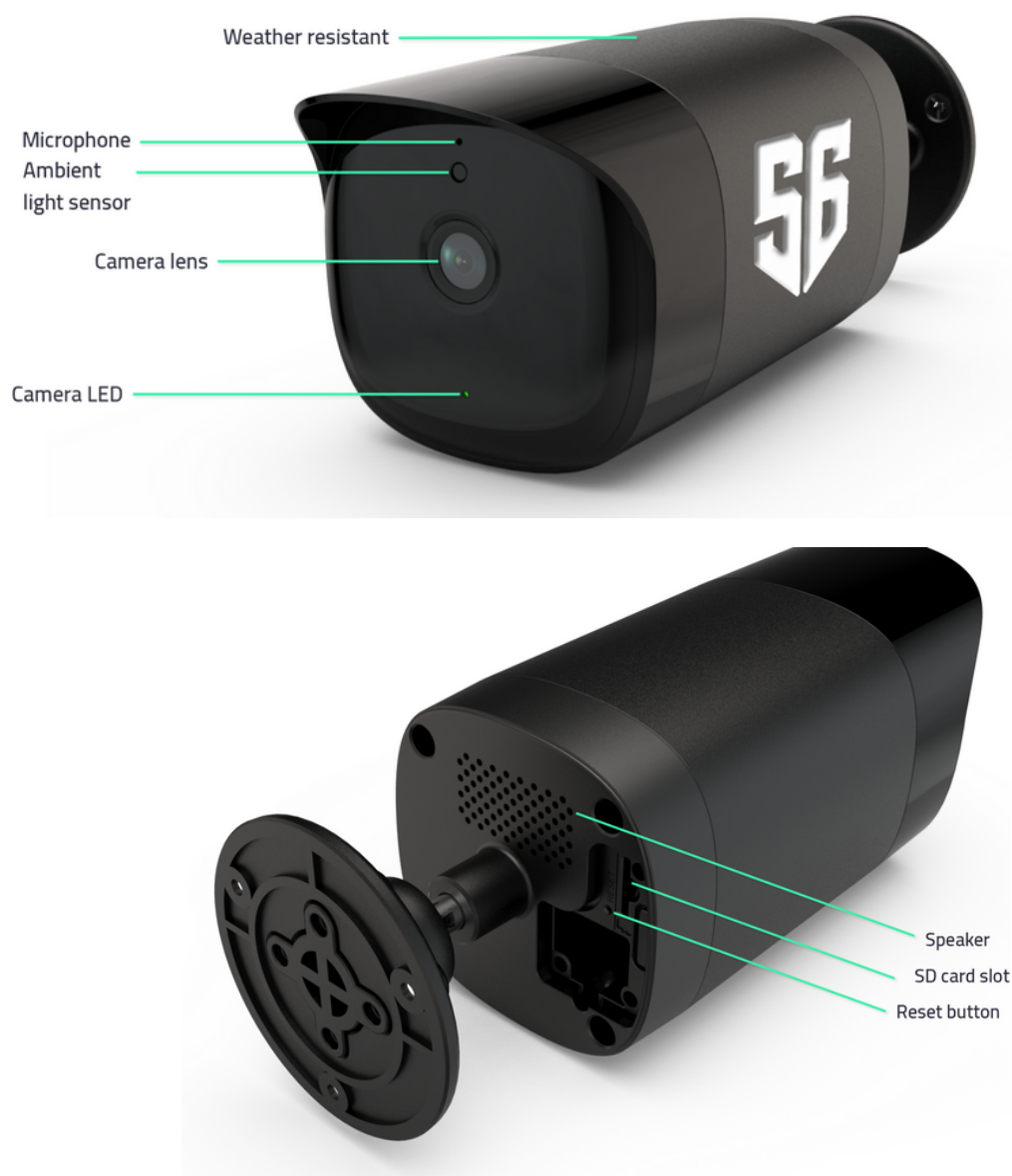

Features



AI Detection

The camera can differentiate between known people, unknown people, pets, and vehicles.



Facial Recognition

Add up to 200 known users into your database.



Real-time Updates

Automatically get live alerts about any activity detected by your camera as they happen.



Smart Reports From Footage

Get detailed reports every day based on the time of day. Capture and visualize color coded events for easy monitoring.



1080P & Starlight Night Vision

Identify a objects and faces whether it is day or night.



Local Processing & Storage

Never have any concerns about your privacy. The feed from your cam stays on your cam unless there is an alert.



2-way Communication

Inbuilt mic and speaker allows you to interact from your phone through the camera.

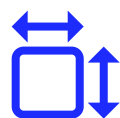

AI Detection Zone

Track events from your camera from a specific area of the footage.



AI Siren

Automatically set off a built-in 100dB siren when the camera detects a person, pet or car.

Get the 56 Secure app

Download the 56 Secure app to get 360° protection for your home, family and yourself. It is available in Google Playstore and Apple App Store.



[Download the app](#)



NOTE: If you already use the 56 Secure app, make sure to update the app to the latest version.

Pairing the camera to your smartphone

1. Open the app.
2. Select "Camera" from the menu at the bottom.
3. Click on the 'Get Started' option
4. Select the camera
5. Switch on the camera, and wait (15 seconds) till the indicator turns green (blinking light)
6. Connect the camera to the preferred WiFi and enter your credentials.
7. Select the location of where you want to place the camera.
8. Next, point the QR code on your app towards the camera from a 15 cm distance to pair the device. We suggest you do this before you mount the camera into its position.
9. Your camera is now ready to use!

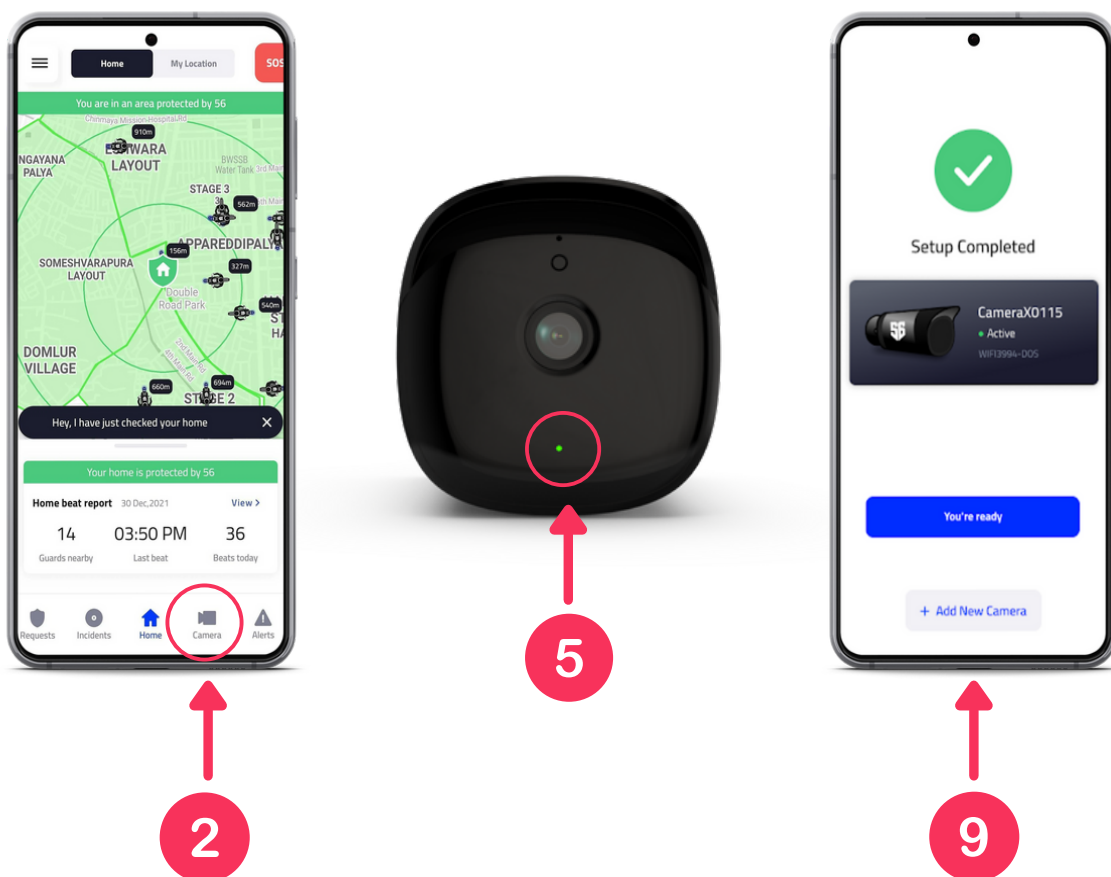

NOTE: We request you to complete pairing the camera to your smartphone before you fix it on the wall/ceiling.

Camera interface

Manage all active cameras from a single display.

Camera 1 →

Camera 2 →

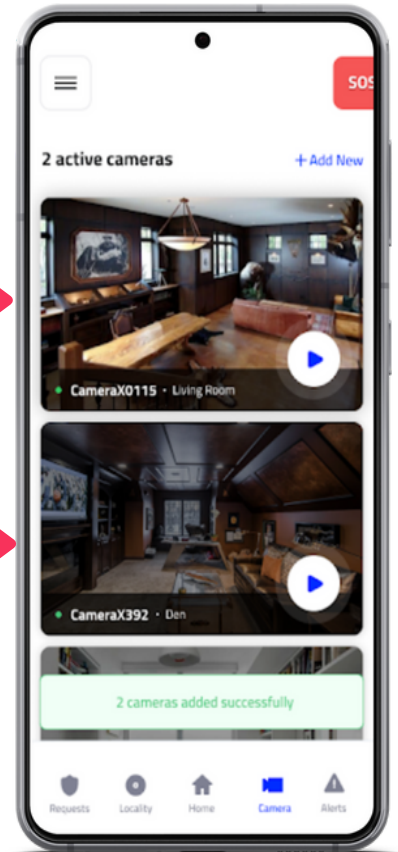

Menu options

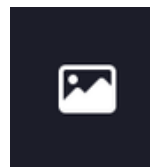
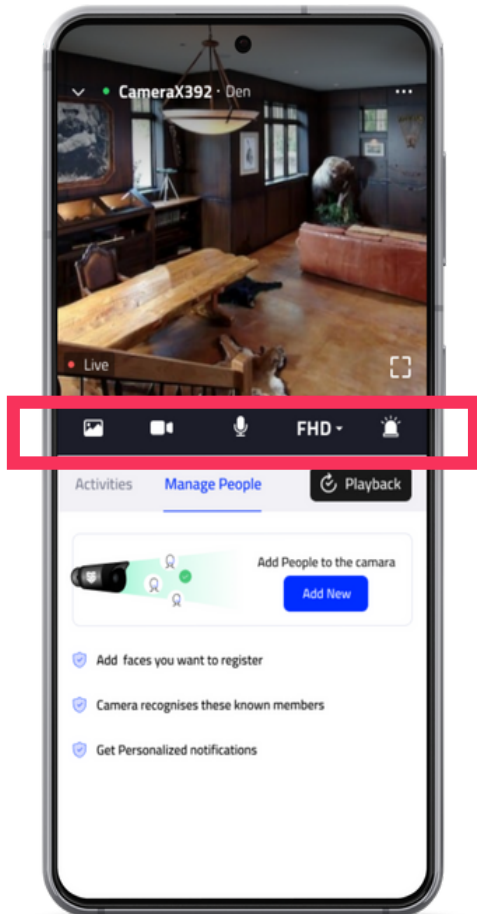

Tap to take a screenshot of the live camera footage

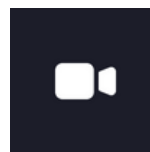

Tap to record the live camera footage

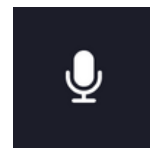

Tap to turn on the mic to speak from the camera



You can adjust the quality of footage being recorded

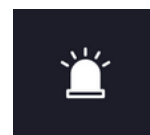

Tap to trigger a siren from the camera

Activity section

Detect unknown visitors

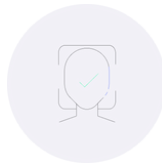

Identify verified users by name

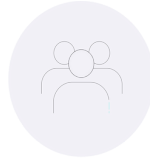

Detect pets



Detect vehicles

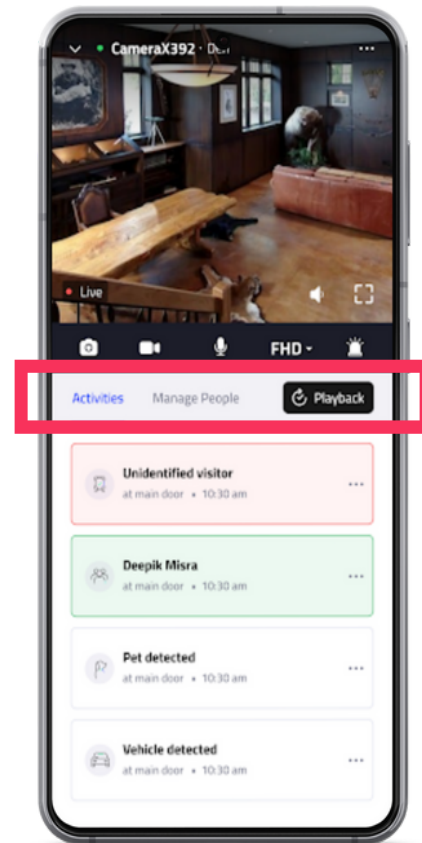

Playback section

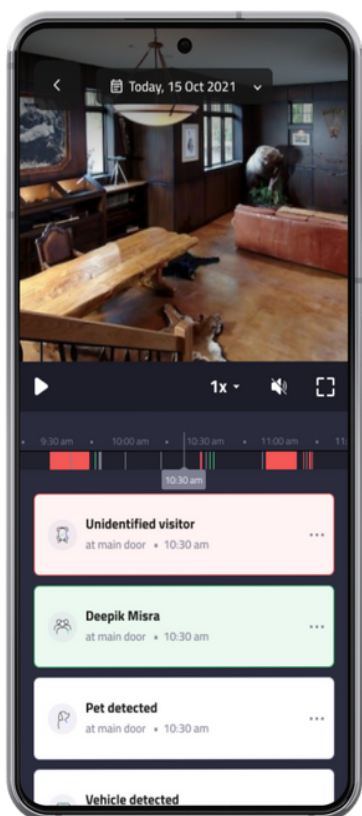

You can see color-coded footage for every event

Control the speed of the playback as per your convenience

You can control the speed of your playback

Tap on any event to download the recording to your device

Adding a new user

Select "Face library" by selecting settings from the top-right on the homepage

Tap on add new user and click a photo from your phone

The user is added once the image has been verified

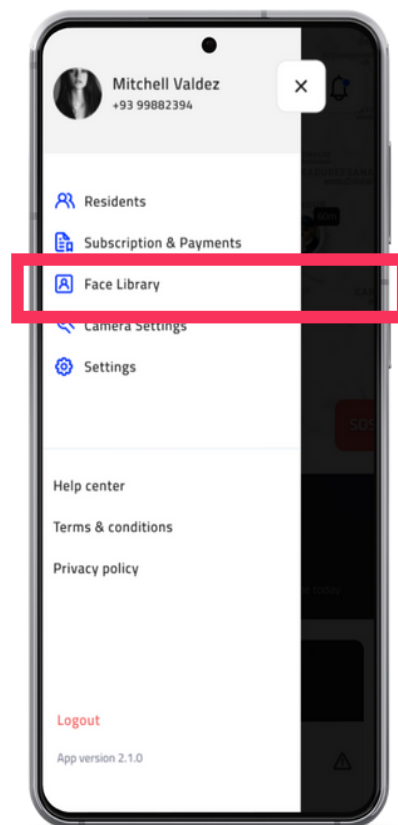

Manage camera storage

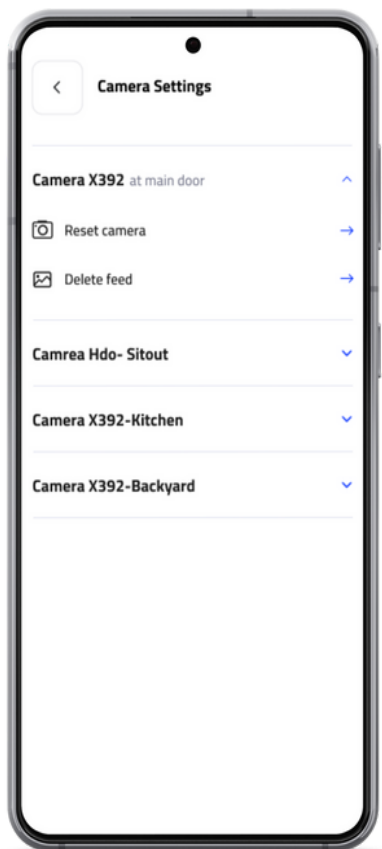

Open the Camera section from the home page

Choose a specific camera

You can choose to "Reset" the camera or "Delete feed".

NOTE: Each camera has an SD card that can store up to 128 GB of videos and other data.

Alerts section

Select Alerts from the homepage menu

Get a detailed summary of events during the morning, afternoon, and night

Get real-time notifications when any activity is detected

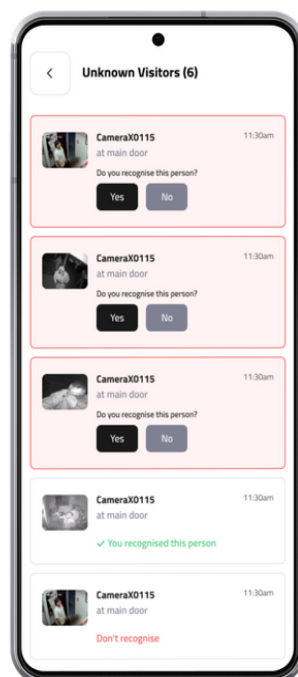
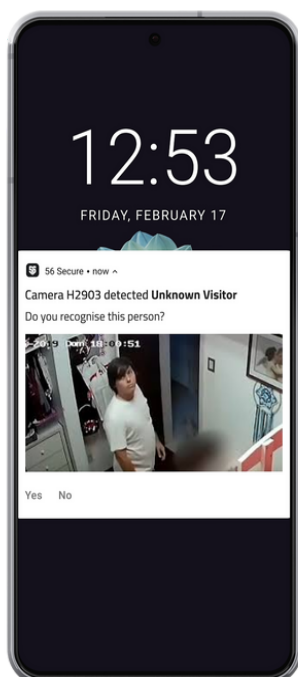
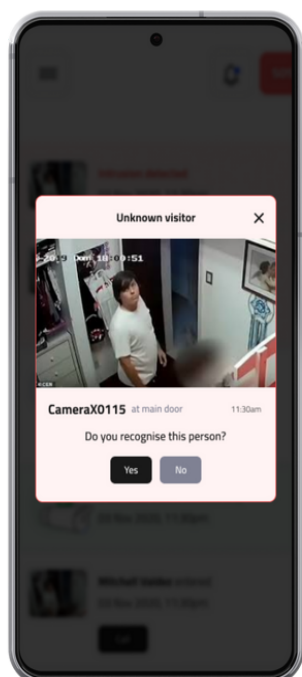
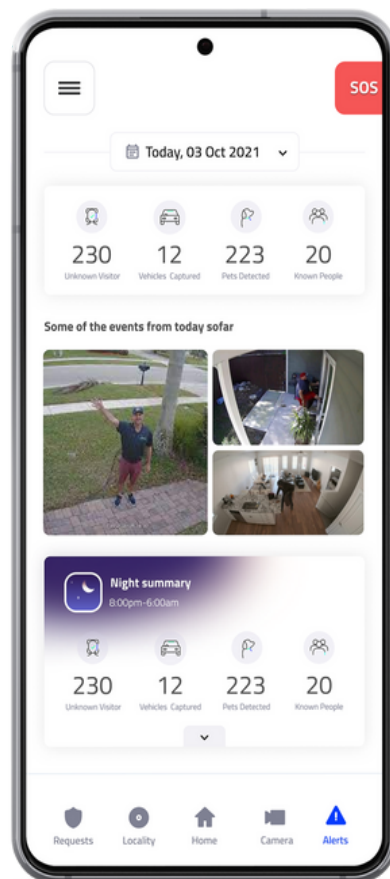

PRO TIP: You can click the SOS option when you need our guards to deescalate the situation with an intruder.

Creating AI detection zone

Open the Camera section from the home page

Select the options icon from the bottom of the screen

Select detection zone

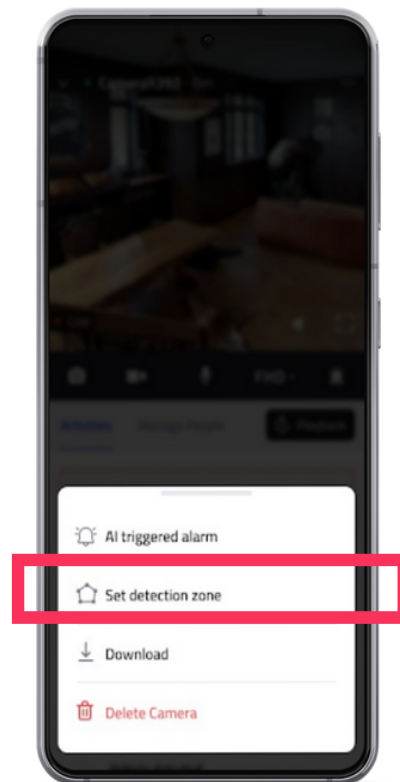

Tap on upto 8 different points on the screen to define the activity zone like above

Select "Save" to confirm the selection

The AI detection zone allows you to detect activities that occur only in that particular zone

NOTE: Having an AI zone is especially useful if you have the camera facing a road sidewalk and you don't want alerts everytime a stranger passes by.

Using AI triggered siren

Open the Camera section from the home page

Select the options icon from the bottom of the screen

Select AI triggered siren

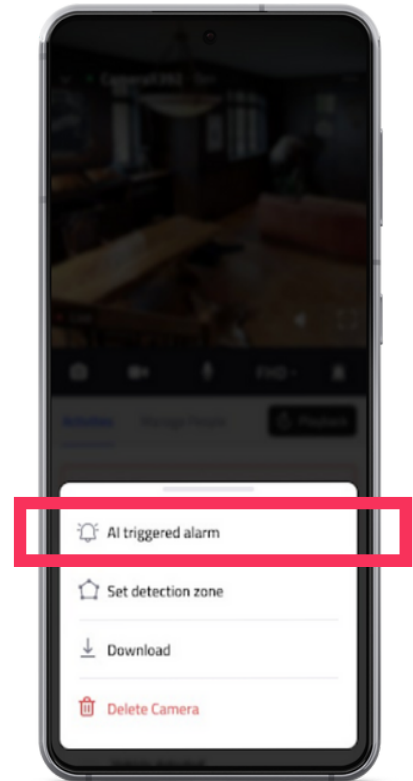

Select the condition that triggers the alarm

Enter the working date and time

Select "Add new" to save changes.

Example: You can activate the AI siren to auto-detect events and ring an alarm during your bed time.

Using Mic & Speaker

Select Camera from the homepage

Tap the  icon to speak through the camera

Tap on the Fullscreen icon within a camera to use the speaker

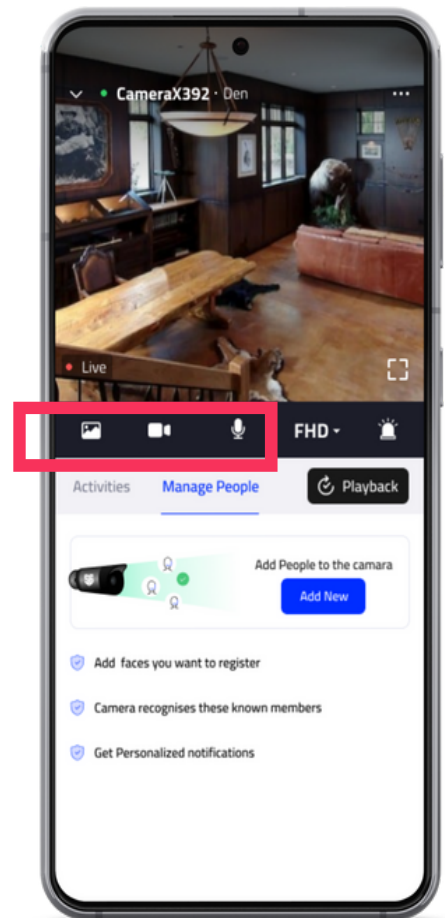

Out of Range

Make sure that your camera is close enough to receive a strong WiFi signal. The range of your router's WiFi signal can vary depending on the router model and conditions in your local environment.

FAQs

AI motion detection:

How many faces can the AI Cam recognize?

-Up to 200 different faces.

How quickly can the AI Cam detect and recognize a face?

-In 30 milliseconds. Actual processing time may be affected by environmental factors such as light or distance.

Does the AI need training?

-No, we have trained AI Cam beforehand and built highly accurate algorithms into the device. However, you can teach it to recognize new things with the SDK which will be available later.

Can it run all the AI features simultaneously?

-Yes, it can detect persons, pets, vehicles, and recognize faces all at the same time.

Video Privacy:

Will you use my data to train AI like Nest and Arlo?

-No, because the AI Cam uses entirely local AI processing, we never have access to your data.

Can someone else monitor my camera like Ring?

-No, only you can view the video through the paired app. The live videos are streamed directly into your phone on a secured P2P (peer-to-peer) network without going through a server.

Can I turn the camera OFF while I'm home?

-Yes, you can manually turn on or off the camera on the APP. You can use geofencing to automatically turn off the camera whenever you arrive home. You can also set a schedule to determine the camera's working hours.

Connectivity:

Will the AI Cam work when the internet is down?

-The local AI will keep analyzing and recording events even without a WiFi connection, but you will not be able to live recordings until the connection is restored.

Installation & Hardware:

How far can I place the camera from the router?

-Up to 20 meters without obstacles.

What if I have to place the camera far away from a power outlet?

-There is a 3-meter extension cable you can purchase to extend the range.

Does 56 AI Cam come with the region's corresponding power plug?

-Yes, the camera will come with the proper type of power plug according to your shipping country.

Event Alert & Recording:

How quickly are alerts sent from the AI cam?

-Push notifications are usually sent within 1 to 2 seconds. However, it may vary depending on your Internet condition.

How quickly can the AI Cam start recording when it detects an event?

-It can recognize a person and start recording within 0.03 seconds - faster than the blink of an eye!

What is the recording length of an event?

-It is adjustable from 15 seconds, 30 seconds to 60 seconds.

Can I customize the notifications?

-You can enable or disable the notifications for people, individual face ID, pets, or vehicles from the app.

Storage:

What will happen when the SD card is full?

-The system records in a continual loop. When the card is full, it begins to overwrite the oldest stored footage.

How many days of video can be stored?

-It depends on the capacity of your SD card and also the quality of the video being recorded. Typically, a 32GB SD card can store 1 week of video footage.

Account:

Can multiple users access one camera?

-All added users from an account can view the camera's live footage and receive notifications.

How many cameras can I use under one account simultaneously?

-There is no limit as long as the bandwidth of your network is sufficient.

Optimal working condition:

Works accurately when the person stands:

- Within 3 meters in the front of the camera
- At a height under <7.5 ft

Highlights

Technical Capability

99.48% recognition accuracy

Trained on tens of millions of images 56 AI facial recognition achieves an accuracy rate of LFW-tested 99.48%. The enhanced algorithm ensures the success of recognition for various face angles and lighting conditions.

High scalability

One standard 56 AI Cam can recognize up to 200 different faces. The database can be expanded to 2,000 faces and supports bulk uploading. There is no limit on the number of faces that the camera can recognize at the same video frame.

Recognition in a blink

Powered by the industry-leading 10nm AI processor, 56 AI Cam can recognize a registered face in around 0.1 second.

No privacy breach

The face images are stored and processed locally on the devices. The video streaming is secured by bank-level encryption.

Contact Support

For any issues and support you can reach out to us:

- From your homepage, select ☰ icon.
- Select "Help Center" from the menu that appears.
- Choose your mode of contact to reach out to us.
- Our support team will assist you as soon as possible.

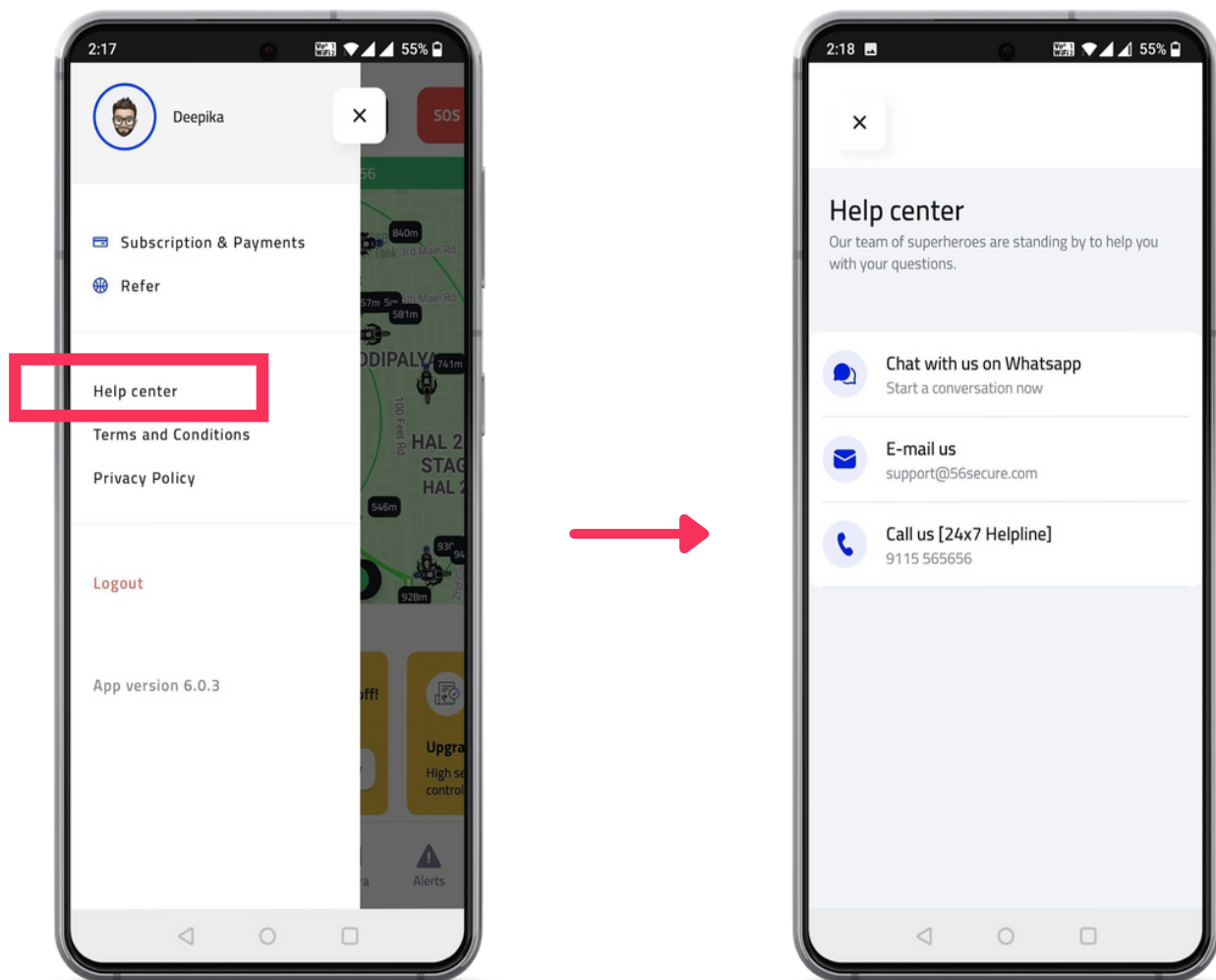

Think Safety, Think 56!